

House EH3

A beautifully styled light-filled home that seamlessly blends period features and modern design

Experience a real sense of arrival as you step into the large entrance hall, leading to the spacious open plan kitchen, dining, living area and balcony with views over the garden. Natural light reaches every corner of this vast space thanks to the large skylight beyond the original, restored iron roof trusses. The contemporary kitchen includes a large island with casual seating whilst the dining area is fantastic entertaining space.

The beautiful master bedroom with its high ceiling is bright and spacious with an impressive en suite bathroom and dressing area. Doors set within the stylish exposed glazed brick wall open onto the private west facing terrace – the perfect spot for enjoying an evening drink whilst admiring beautiful garden space and woodland views.

A skylight floods the second and third bedroom with natural light. These spacious bedrooms with high ceilings also benefit from a perfectly positioned luxurious bathroom. The fourth bedroom is an excellent space, with the flexibility to be used as a home office.

Dimensions
Total Area: 2272 sq ft (211.1 sq m)

Living/Kitchen/Dining (max.)	35' 0" x 19' 7"	(10.6m x 5.9m)
Master Bedroom (max.)	26' 0" x 19' 9"	(7.9m x 6.0m)
Bedroom 2 (max.)	14' 4" x 9' 8"	(4.3m x 2.9m)
Bedroom 3 (max.)	14' 4" x 9' 8"	(4.3m x 2.9m)
Bedroom 4 (max.)	14' 11" x 14' 2"	(4.5m x 4.3m)
Garden (max.)	98' 0" x 16' 4"	(29.9m x 5.0m)

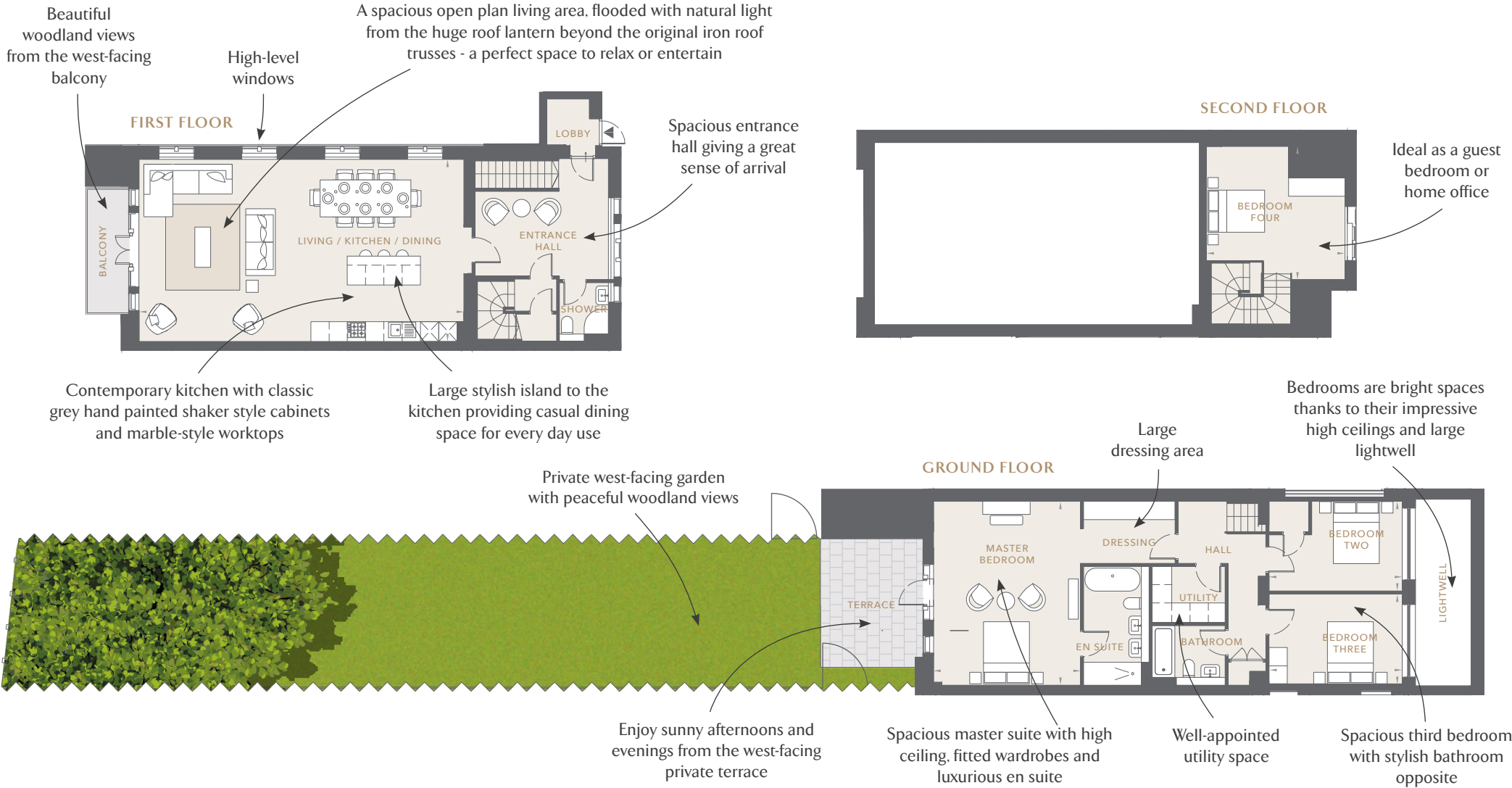
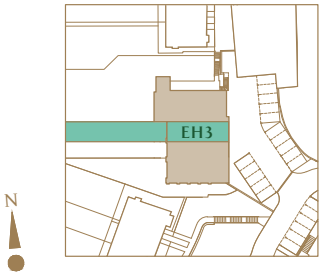

Photography shown of similar City & Country properties. Computer generated images are indicative only.